



# SMART-CAL™

Calibrates SENSIT® and Trak-It® instruments, stores data and manages instrument testing compliance.

**SMART-CAL Calibration Station** performs automated calibration and record keeping for SENSIT® and TRAK-IT® series instruments equipped with a 2-Way Infrared Communications Window.

**SMART-CAL Calibration Station** can perform bump tests and calibrate instrument sensors. It also performs flow-block tests and allows you to adjust instrument clock, time and date settings.

The User Menu allows you to download and review instrument data on screen. The on-board memory can store up to 2450 records. The calibrator can be used as a stand-alone device or with **SCAL-D** Data Management Software.

**SCAL-N** is the Network version of the software. **SCAL-N** is sold separately with a multi-year license. Use **SCAL-N** to download data from remotely located Calibration Station(s). Data is stored in SQL Server.

## **SMART-CAL Calibration Station is**

- Easy to Use
- Easy to Maintain
- Made in USA



## **Standard Features:**

- Push Button Operation
- Backlit LCD Display
- Line of Sight IR Communication
- Date/Time Display
- Automatic Date Adjustment
- Automatic Upload
- Calibration Memory
- Compatible with Windows 7, 8, 8.1

## **SMART-CAL™ Reporting Features:**

- Instrument Test Past Due
- Instrument Failure Alerts
- Monthly Compliance Report
- Sensor Performance Data
- Optional Networking System
- Compatible with:
  - SCal-D™ (Desktop)
  - SCal-N™ (Network)Data Management Software

## **Available Test Gases\***

- PPM (Methane)
- LEL (Methane)
- LEL (Propane)
- % Volume
- Carbon Monoxide - CO
- Hydrogen Cyanide - HCN
- Hydrogen Sulfide - H2S
- Nitrogen - N2
- Ethane - C2H6

\*Contact Sensit Technologies for more info.

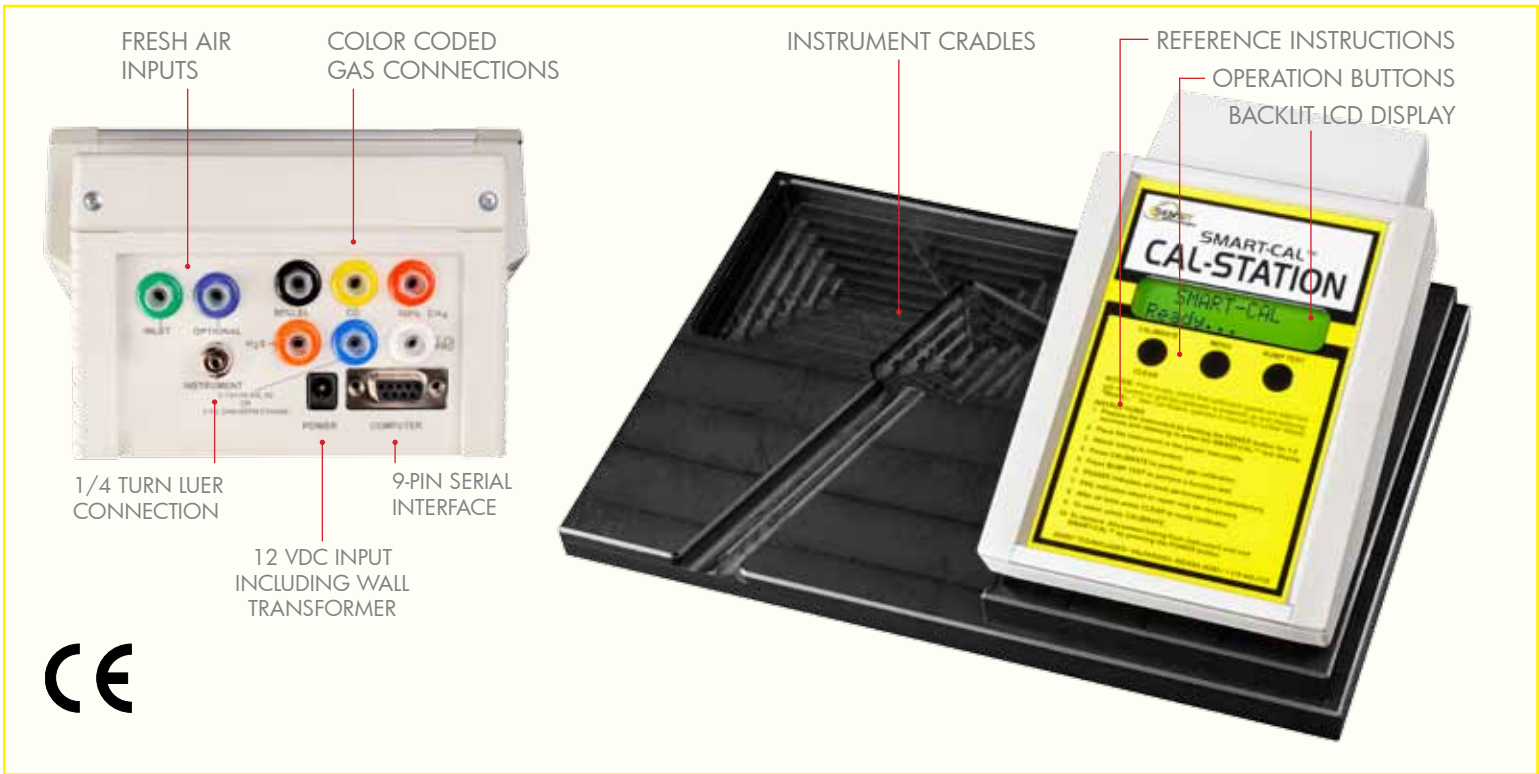

**PRODUCT SPECIFICATIONS**

Size: 10.75" x 6.75" x 4.5" (27.3cm x 17.1cm x 11.4cm)  
 Weight: 2.5 lb. (1.13 kg)  
 Operational Temp: 32 to 120 F (0 to 48.9° C)  
 Max. Inlet Pressure: 20 PSI  
 Power: 110 - 240VAC Input with 12VDC Output

**SOFTWARE REQUIREMENTS**

30MB Hard Drive Space  
 Windows® 7, 8, 8.1 Operating System  
 Microsoft® Outlook  
 Microsoft Excel



**DATA MANAGEMENT SOFTWARE**

**SCAL-D** is the Desktop version of the software. This single-user software application comes standard with Calibration Stations.

Various reports and alerts can be viewed, printed, emailed or stored as an Excel spreadsheet. When configured, it will automatically alert operators and supervisors of important data depending on their preference.

**SCAL-N** is the Network version of the software. SCAL-N is sold separately with a multi-year license. Use **SCAL-N** to download data from remotely located Calibration Station(s). Data is stored in SQL Server.

## SMART-CAL™ Calibration Stations

SMART-CAL Auto Calibration Station  
Part # 914-00000-01

Includes: SCAL-D (Desktop) Data Management Software for Windows XP & Win 7,  
Installation Guide, Cables, 2 Year Technical Support

SMART-CAL Auto Calibration Station - Network  
Part # 914-00000-04

Includes: SCAL-N (Network) Data Management Software 1 Network Admin Disc,  
1 Network User Disc for Windows XP & Win 7, Installation Guide, Network Adapter,  
2 Year Technical Support

## Auto Bump and Calibration Gas Kits for Instruments:

### SENSIT® GOLD & Trak-It® III Series

SMART-CAL Standard Gas Kit 221  
221 liter combo gas (2.5% CH<sub>4</sub> / 100ppm CO)  
Part # 881-00045

#### For Instruments with TC Sensor:

100% Methane 21 liter (100% CH<sub>4</sub>)  
Part # 315-080007

Calibration Reg Assy 21L Bottle (For use with 100% CH<sub>4</sub> and Propane)  
Part # 880-00013

#### For Instruments with H<sub>2</sub>S Sensor:

SMART-CAL Gas Kit H<sub>2</sub>S only (58L)  
Part # 881-00047

### SENSIT® PMD

SMART-CAL Gas Kit for PMD  
Part # 881-00074

Please consult with your local representative and/or Sensit Technologies for other  
SMART-CAL gas kits.

## Replacement Cylinders

Combo Gas 221 liter (2.5% CH<sub>4</sub> / 100ppm CO)  
Part # 315-180028

100% Methane 21 liter (100% CH<sub>4</sub>)  
Part # 315-080007

1.1% Propane 221 liter  
Part # 315-180004

100ppm CO/Air 221 liter  
Part # 315-180005

25ppm H<sub>2</sub>S/Air 58 liter  
Part # 315-120001

100% Methane 116 liter (100% CH<sub>4</sub>)  
Part # 315-220005

0.1% Methane/Air 103 liter  
Part # 315-140006

10ppm HCN/Nitrogen 34 liter  
Part # 315-100006

100ppm Ethane/Nitrogen 58 liter  
Part # 315-120010

1000ppm CH<sub>4</sub>/10ppm Ethane 58 liter  
Part # 315-120015

Contact SENSIT to discuss calibration kits for line gas.



851 Transport Drive  
Valparaiso, IN 46383-8432

Phone: 888 4SENSIT  
888 473 6748  
219 465 2700

Fax: 219 465 2701  
www.gasleaksensors.com

MADE IN USA

SENSIT Technologies  
is in compliance with ISO 9001:2008



Distributed by:

